



Modello model modèles modelo Modelle	Dimensioni d'ingombro overall dimension dim. d'encombrement dimensiones Größe	Dimensioni camera size of the chamber dim. de la chambre dim. de la cámara Kammergröße	Barra saldante sealing bar barre de soudure barra soldante Schweißleiste	Pompa del vuoto vacuum pump pompe du vide bomba de vacío Vakuumpumpe	Tensione voltage voltage tensión Spannung
TOP	570x660x530 H	470x530x220 H	mm 450	Q= 25 m³/h-OIL	230V/50 Hz
ULTRA	760x670x1150 H	660x530x230 H	2x(mm 500)	Q= 60 (100)m³/h-OIL	380 V/50-60 Hz
MEGA	900x800x1150 H	830x660x230 H	2x(mm 600)	Q= 100 m³/h-OIL	380 V/50-60 Hz
JUMBO	1150x800x1150 H	1050x660x230 H	mm1000 / mm550	Q= 100 (200)m³/h-OIL	380 V/50-60 Hz
SUPERMEGA	1900x800x1150 H	(830x740x230 H) x2	(mm 800) x4	Q= 100 m³/h-OIL	380 V/50-60 Hz

Modello model modèles modelo Modelle	Dimensioni d'ingombro overall dimension dim. d'encombrement dimensiones Größe	Dimen. max. contenitore maximum container dimension dimension maximum du pot dimension maxima contenedor Maximum Behälter Dimension	Potenza installata installed power puissance installée potencia instalada Installiert Macht	Ciclo di lavoro working cycle cycle de travail ciclo de trabajo Arbeitszyklus	Pompa del vuoto vacuum pump pompe du vide bomba de vacío Vakuumpumpe	Comandi controls commandes mandos Anschaltung	Press. max. max. pressure pression maximale máxima presión Maximaler Druck	Tensione voltage voltage tensión Spannung
SV 300 LCD	280x500x600 H open	mm 265x196	600 W	semi-automatic	-	digit led + sensor-VAC	-	230 V/50 Hz
SV 400 LCD	400x500x600 H open	mm 265x325	1200 W	semi-automatic	-	digit	-	230 V/50 Hz
VG 600 LCD	610x600x560 H	mm 265x325	1800 W	automatic	Q= 25 m³/h	digit led + sensor-VAC	± 3 BAR	230 V/50 Hz
VG 800 LCD	610x600x1100 H	mm 265x325	1800 W	automatic	Q= 25 m³/h	digit led + sensor-VAC	± 3 BAR	230 V/50 Hz

Modello model modèles modelo Modelle	Dimensioni d'ingombro overall dimension dim. d'encombrement dimensiones Größe	Filtro esterno per liquidi external fluid filter filtre externe pour liquides filtro externo para líquidos Außerfilter für Flüssigkeit	Ciclo di lavoro working cycle cycle de travail ciclo de trabajo Arbeitszyklus	Pompa del vuoto vacuum pump pompe du vide bomba de vacío Vakuumpumpe	Comandi controls commandes mandos Anschaltung	Tensione voltage voltage tensión Spannung
GASTROSYSTEM	390x280x250 H	standard	automatic	Q=10 m³/h-OIL	analogic	230 V/50 Hz



# SINTESI S.r.l.

**Soluzioni per l'industria**  
 Via F. Lippi 22/E - 50038 Scarperia (FI)  
 Tel. 055 8430571 - Fax 055 846646  
 Partita IVA e Cod. Fisc. 05839550489  
 www.sintesticom.it - sintesi@sintesticom.it

*Dalla Toscana per esservi vicini nella vendita, nell'assistenza, nel servizio. Con costi contenuti e merce pronta.*

**CHIAMATECI**

*non costa niente e... magari risolvete un problema.*

[www.sintesticom.it](http://www.sintesticom.it)

## ASPIRAZIONE ESTERNA / EXTERNAL ASPIRATION



### MINI SERIES

Modello model modèles modelo Modelle	Struttura structure estructura Struktur	Dim. d'ingombro overall dimension dim. d'encombrement dimensiones Größe	Barra saldante sealing bar barre de soudure barra soldante Schweißleiste	Pompa del vuoto vacuum pump pompe du vide bomba de vacío Vakuumpumpe	Tensione voltage voltagge tensión Spannung
FRESH ABS	ABS	380x180x80 H	mm 300	Q= 10 LT/MIN	230 V/50 Hz
MINI MINI	INOX ANALOGIC	370x260x130 H	mm 350	Q= 15 LT/MIN	230 V/50 Hz
MINI BIG	INOX ANALOGIC	470x260x130 H	mm 450	Q= 15 LT/MIN	230 V/50 Hz
SMALL	INOX DIGIT	370x280x170 H	mm 350	Q= 15 LT/MIN	230 V/50 Hz
ELIX	INOX DIGIT	420x280x170 H	mm 400	Q= 15 LT/MIN	230 V/50 Hz
MEDIUM	INOX DIGIT	520x280x170 H	mm 500	Q= 40 LT/MIN	230 V/50 Hz
EASY PACK	INOX DIGIT AUT.	370x280x200 H	mm 350	Q= 40 LT/MIN	230 V/50 Hz
MINIPACK	INOX DIGIT AUT.	420x310x210 H	mm 400	Q= 40 LT/MIN	230 V/50 Hz
1000 B	INOX DIGIT AUT.	470x380x230 H	mm 450	Q= 6 m <sup>3</sup> /h-OIL	230 V/50 Hz
2000	INOX DIGIT AUT.	520x380x230 H	mm 500	Q= 6 m <sup>3</sup> /h-OIL	230 V/50 Hz
2000 S	INOX DIGIT AUT.	570x380x230 H	mm 550	Q= 6 m <sup>3</sup> /h-OIL	230 V/50 Hz

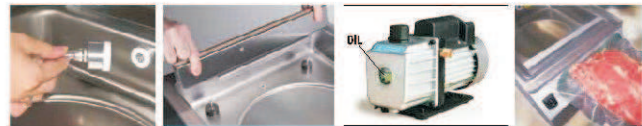

## A CAMPANA DA BANCO / TABLE TOP MACHINE

Modello model modèles modelo Modelle	Dimensioni d'ingombro overall dimension dim. d'encombrement dimensiones Größe	Dimensioni camera size of the chamber dim. de la chambre dim. de la cámara Kammergröße	Barra saldante sealing bar barre de soudure barra soldante Schweißleiste	Pompa del vuoto vacuum pump pompe du vide bomba de vacío Vakuumpumpe	Tensione voltage voltagge tensión Spannung
UNIVERSAL	370x530x250 H	310x350x120 H	mm 300	Q= 6 m <sup>3</sup> /h-OIL	230 V/50 Hz
OPTIMA	420x530x400 H	360x400x190 H	mm 350	Q= 10 m <sup>3</sup> /h-OIL	230 V/50 Hz
UNICA	470x550x430 H	410x450x220 H	mm 400	Q= 12 m <sup>3</sup> /h-OIL	230 V/50 Hz

### NEW SERIES



## ECONOMY SERIES



## PROFESSIONAL SERIES



## PROFESSIONAL PLUS SERIES



Tensione voltage voltagge tensión Spannung
230 V/50 Hz
230 V/50 Hz
230 V/50 Hz



## TOP SERIES



Modello model modèles modelo Modelle	Dimensioni d'ingombro overall dimension dim. d'encombrement dimensiones Größe	Dimensioni camera size of the chamber dim. de la chambre dim. de la cámara Kammergröße	Barra saldante sealing bar barre de soudure barra soldante Schweißleiste	Pompa del vuoto vacuum pump pompe du vide bomba de vacío Vakuumpumpe	Tensione voltage voltagge tensión Spannung
DG 25	360x400x400 H	260x300x180 H	mm 250	Q= 6 m <sup>3</sup> /h-OIL	230 V/50 Hz
DG 30	410x460x420 H	310x350x190 H	mm 300	Q= 10 m <sup>3</sup> /h-OIL	230 V/50 Hz
DG 35	460x500x420 H	360x400x190 H	mm 350	Q= 10 m <sup>3</sup> /h-OIL	230 V/50 Hz
DG 40	510x560x450 H	410x450x220 H	mm 400	Q= 25 m <sup>3</sup> /h-OIL	230 V/50 Hz
DG 45	560x610x450 H	460x500x220 H	mm 450	Q= 25 m <sup>3</sup> /h-OIL	230 V/50 Hz
DG 80	910x540x450 H	810x420x160 H	2 x mm 400	Q= 25 m <sup>3</sup> /h-OIL	230 V/50 Hz
START LCD	360x400x400 H	260x300x160 H	mm 250	Q= 6 m <sup>3</sup> /h-OIL	230 V/50 Hz
BABY LCD	410x460x420 H	310x350x190 H	mm 300	Q= 10 m <sup>3</sup> /h-OIL	230 V/50 Hz
SPEEDY LCD	460x500x420 H	360x400x190 H	mm 350	Q= 10 m <sup>3</sup> /h-OIL	230 V/50 Hz
JOLLY LCD	510x560x450 H	410x450x220 H	mm 400	Q= 25 m <sup>3</sup> /h-OIL	230 V/50 Hz
BOXER 45 LCD	560x610x450 H	460x500x220 H	mm 450	Q= 25 m <sup>3</sup> /h-OIL	230 V/50 Hz
BOXER 50 LCD	600x560x450 H	500x460x220 H	mm 500	Q= 25 m <sup>3</sup> /h-OIL	230 V/50 Hz
BOXER DUO LCD	600x560x450 H	500x460x220 H	2x(mm 450)	Q= 25 m <sup>3</sup> /h-OIL	230 V/50 Hz
BOXER/L LCD	560x610x1050 H	460x500x220 H	mm 450	Q= 25 m <sup>3</sup> /h-OIL	230 V/50 Hz
450 LCD	580x660x1050 H	460x560x220 H	mm 450	Q= 25 m <sup>3</sup> /h-OIL	230 V/50 Hz
450/S LCD	680x570x1050 H	560x460x220 H	2x(mm 450)	Q= 25 m <sup>3</sup> /h-OIL	230 V/50 Hz
500 LCD	630x760x1050 H	510x650x220 H	mm 500	Q= 60 m <sup>3</sup> /h-OIL	380 V/50 Hz
550/S LCD	840x680x1050 H	720x570x220 H	2x(mm 550)	Q= 60 m <sup>3</sup> /h-OIL	380 V/50 Hz
900/S LCD	1040x680x1050 H	920x570x220 H	mm 900/500	Q= 100 m <sup>3</sup> /h-OIL	380 V/50 Hz
1000/S LCD	1140x590x1050 H	1020x420x200 H	mm 1000	Q= 60 m <sup>3</sup> /h-OIL	380 V/50 Hz
550/S DUPLEX LCD	1680x680x1050 H	(720x570x220H) x2	(2xmm550) x2	Q= 100 m <sup>3</sup> /h-OIL	380 V/50 Hz
500 VARIANT LCD	670x410x1000 H	510x160x450 H	mm 500	Q= 25 m <sup>3</sup> /h-OIL	230 V/50 Hz

## A CAMPANA SU RUOTE / CHAMBER MACHINE ON WHEELS

### LAPACK SERIES

